

FLANGE MOUNT CABLE STRAIGHT JACK

R128.292.020

SERIES

BMA

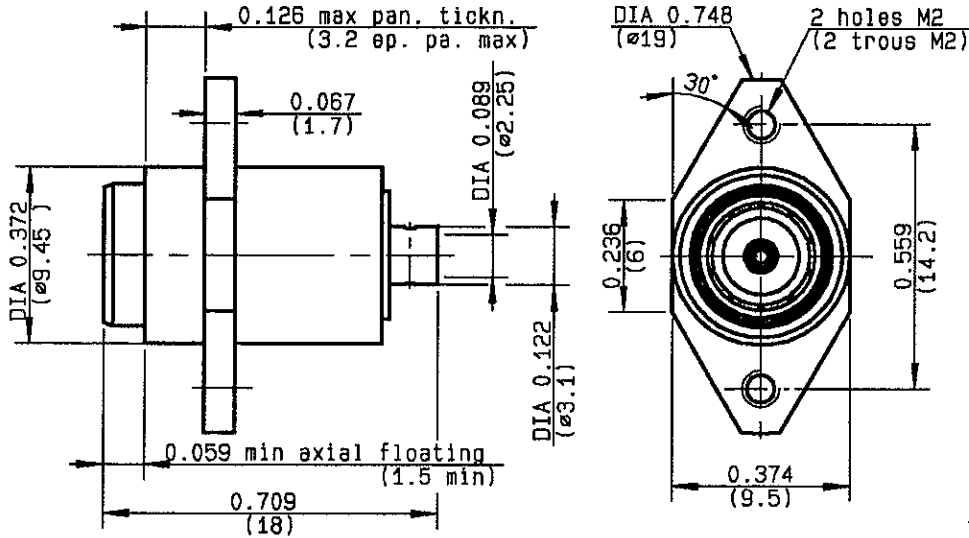

PERCEGE PANNEAU
MOUNTING HOLE

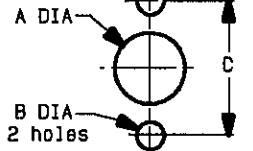

	MM		INCH	
	maxi	mini	maxi	mini
A	9.6	9.55	0.378	0.376
B	2.2	2.1	0.087	0.083
C	14.3	14.1	0.563	0.555

NOMINAL IMPEDANCE	50 Ω
FREQUENCY RANGE	0-22 GHz
TEMPERATURE RATING	-65/+125 °C
V.S.W.R	1.07 + .01 x F(GHz)Maxi
RF INSERTION LOSS	0.03 √F(GHz) dB Maxi
VOLTAGE RATING	350 Veff Maxi
DIELECTRIC WITHSTANDING VOLTAGE	1000 Veff Mini
INSULATION RESISTANCE	5000 MΩMini
HERMETIC SEAL	NA Atm.cm ³ /s
LEAKAGE (pressurized only)	NA
MECHANICAL DURABILITY	1000 Cycles
WEIGHT	5 gr
SPECIFICATION	

CABLES : **KS 1**
RG 405

OTHERS CHARACTERISTICS

CABLE RETENTION	136 N Mini
CENTER CONTACT RETENTION	
Axial force - mating end	27 N Mini
Axial force - opposite end	27 N Mini
Torque	NA cm.N Mini
RECOMMENDED TORQUES	
Mating	NA cm.N
Panel nut	NA cm.N
Clamp nut	NA cm.N

CONNECTOR PARTS	MATERIALS	FINISH	(all values are given in micrometers)
BODY	STAINLESS STEEL	GOLD 1.3 OVER NICKEL 2	
OUTER CONTACT	BERYLLIUM COPPER	GOLD 1.3 OVER NICKEL 2	
CENTER CONTACT	BERYLLIUM COPPER	GOLD 1.3 OVER NICKEL 2	
INSULATOR	PTFE	-	
GASKET	-	-	
OTHERS PIECES	BRASS	NICKEL 2	

ISSUE
1013 B

CREATION DATE
30/04/1998

FILE PART-NUMBER
98-0732-006



RADIALL®

ZANETTE

The information given here is subject to change without notice.
Design changes may be in order to improve the product.

Connect to the future



R128.292.020

ISSUE 1013 B SERIES BMA

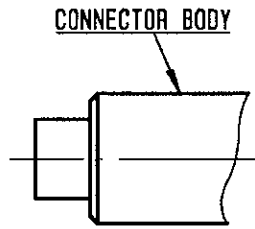

We recommend a thermal preconditionning cable .

①

Strip the cable .
 Stripping tool R282 051 000
 Positioner R282 062 000
 -
 -

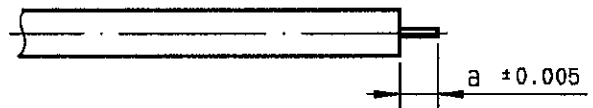

Stripping	a	b	c	d	e
inch	0.07	0	0	0	0
mm	1.78				

②

Trim cable center conductor .
 Trimmer R282 062 000
 -
 -

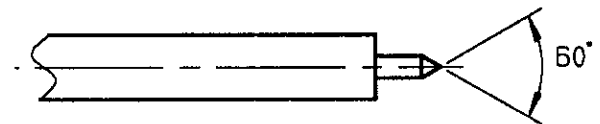

③

Slide cable into connector body until it contacts the body shoulder.
 Place sub assembly into the assembly jig R282 740 000 (or equivalent) with positioner R282 860 100 and tighten it .
 Solder body onto cable .
 Let the assembly cool down before removing it from the jig .
 Clean the solder area.

